



Growtech Industrial Group W.L.L

# PRODUCT CATALOG

## PanelPro



# PanelPro: Innovative Solutions in fabrication and insulation



At the forefront of construction innovation, GTIG has pioneered the development of **pre-bonded panels**. By seamlessly integrating **insulation** that meets international standards of **different materials & cladding, which can be customized in layers** during the manufacturing process, we have created a product that not only boosts **structural integrity** but also significantly **streamlines the installation process**.

This innovative pre-bonding technique not only **saves valuable time on-site** but also **reduces labor costs**, making it a game-changer for both large-scale and smaller projects.

Our commitment to innovation is evident in our products

**Designed to meet the evolving needs of modern construction with efficiency, reliability, and sustainability**

# Why Pre-Bonded Panels are the Choice of Tomorrow

## 1 Consistent Quality

PanelPro is manufactured in controlled & calibrated factory settings, ensuring consistent quality. Factory settings allow for greater control over the materials and workmanship, leading to high quality buildings.

## 2 Eco-friendly Benefits

PanelPro has many environment friendly properties. The pre-bonded panel reduces waste and energy consumption during construction, contributing to more sustainable building practices.

## 3 Improved Safety

PanelPro reduces on-site construction risks, minimized with pre-bonded panels. The need for extensive manual labor is reduced, which can decrease the likelihood of construction accidents. Easy repair and maintenance is an advantageous for long-term building management and upkeep.



**Increase:**  
Noise Isolation\*

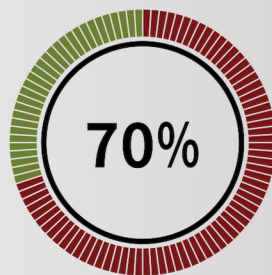

**Reduce:**  
Installation time\*



**Maintain:**  
Heating and cooling\*

\*All inspections and measurements are approximate and internally tested within the factory

# GypsoPro

Model 100mm to Model 200 mm

Introducing our innovative Dual-Side pre-bonded Composite Panel, expertly engineered to combine the benefits of different materials & cladding, which can be customized in a single, robust solution.

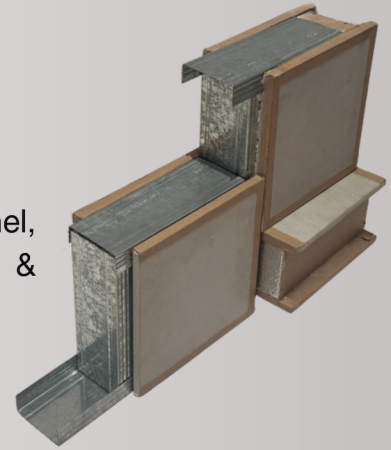

## DUAL-SIDE COMPOSITION

One side of the panel features a waterproof gypsum board and the other is cladded with a cement board layer providing excellent sound isolation, exceptional thermal insulation and moisture resistance.

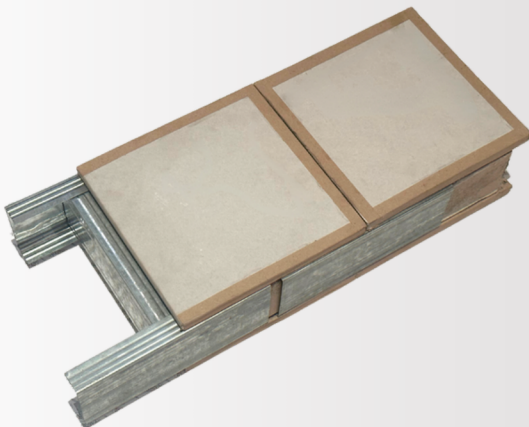

## PRE-BONDED CONSTRUCTION

The cladding of pre-bonded gypsum according to the different applications and site specifications, it's in advance isolation, which strengthens the speed of the installation and the structural integrity and stiffness. The product provides voice isolation, exceptional thermal isolation, humidity resistance and fire rated resistance according to cladding material



## ECO-FRIENDLY AND DURABLE

Our panel is an environmentally conscious choice, contributing to greener building practices in FRP with shorter installation times and longevity in structural integrity,

# From concept to reality: CamLock Pro



Pre-bonded panels revolutionize construction, blending the efficiency of modular construction with unparalleled versatility. They're a game-changer for many building needs. Discover their innovative applications:



## ENGAGED

Align the panels on the bottom channel and insert the Allen key to secure them in place

## COMPRESSED

Rotate the Allen key clockwise to compress the panel joint



## LOCKED

Rotate the Allen key downward to activate the CamLock mechanism

Get In Touch

تواصلوا معنا



**Contact Us :**

 +974 55842290

 khaled@gtig.qa

 www.gtig.qa

 Building 154, Street 21, Zone 81